

Item 11.6.

CITY OF PICKERING

NORTH PICKERING COMMUNITY MANAGEMENT INC.

To construct, reconstruct, erect or place a building or structure, site grade, temporarily or permanently place, dump or remove any material, originating on the site or elsewhere, interfere with a wetland and alter a watercourse on Whites Road/Sideline 26 from Taunton Road to Whitevale Road, in the City of Pickering, Duffins Creek Watershed, as located on the property owned by the Regional Municipality of Durham, DG Group and Infrastructure Ontario.

The purpose is to widen Whites Road/Sideline 26 from Taunton Road to Whitevale Road and extend Whites Road/Sideline 26 from Whitevale Road to approximately the Highway 407 interchange. These works have been divided into two separate permits (CFN 58869 and CFN 60055). This application (CFN 58869) covers the widening of existing Whites Road/Sideline 26 from Taunton Road to Whitevale Road and realignment of a watercourse. These works are part of the servicing for the new Seaton community in the City of Pickering and were previously reviewed through the Central Pickering Development Plan Class Environmental Assessment (EA) for Regional Services (June 2014). The warmwater construction timing window will be applied to this project.

MAP LOCATION: Whites Road (Taunton Road to Whitevale Road)

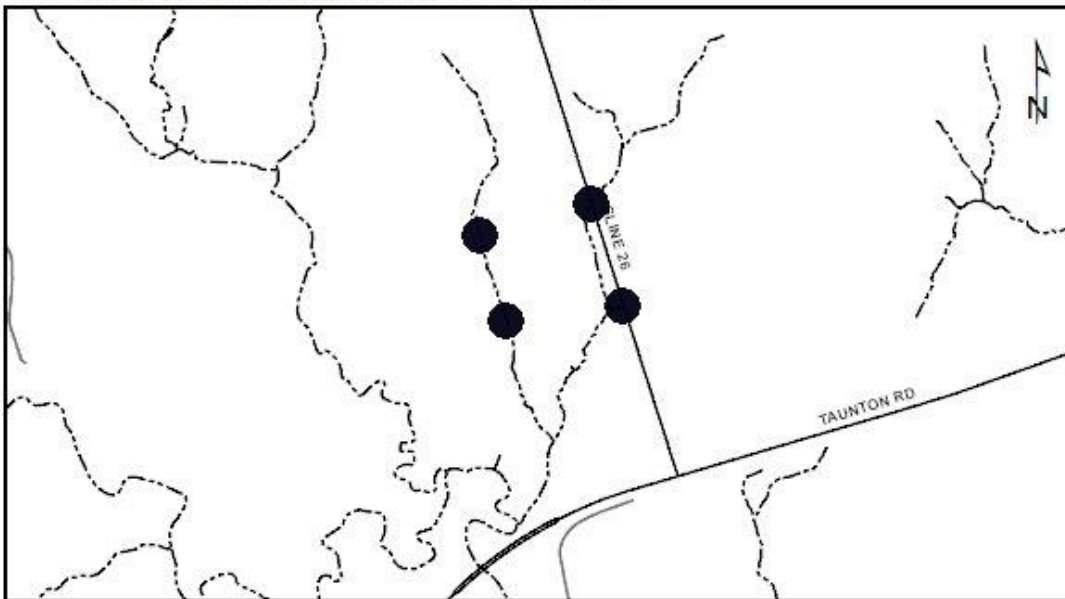

The permit will be issued for the period of May 3, 2019 to May 2, 2021 in accordance with the following documents and plans which form part of this permit:

- **Letter of Undertaking to provide revisions to the engineering and landscape/restoration drawings to the satisfaction of TRCA staff; dated April 22, 2019; received April 22, 2019; prepared by North Pickering Community Management Inc.**

Application-Specific Permit Conditions

14. No work as authorized by the issuance of this permit may be commenced by the permit holder unless and until all conditions precedent as set out in the Licence of Land for Temporary Use and Access between Her Majesty The Queen In Right Of Ontario, as represented by The

Item 11.6.

Minister of Economic Development, Employment and Infrastructure ("I/O") and North Pickering Community Management Inc. or waived by I/O. For greater certainty, the purpose of the foregoing is to ensure that North Pickering Community Management Inc. does not rely on this permit to commence work, or even enter onto the subject lands, unless and until all requisite permissions to enter as granted by I/O are in full force and effect and without outstanding conditions precedent.

RATIONALE

The application was reviewed by staff on the basis of the following information:

Proposal:

This proposal involves the widening of existing Whites Road/Sideline 26 from Taunton Road to Whitevale Road to service the new Seaton Community. The existing 2-lane rural road will be reconstructed to the ultimate urban road configuration of 6 lanes (3 lanes in each direction) between Taunton Road and Whitevale Road plus turning lanes, bike lanes in both directions and sidewalks. A separate permit (C-180521, CFN 58299) for the construction of the water and wastewater systems along Whites Road/Sideline 26 was approved and issued in June 2018 and work is currently underway. However, local water and sanitary connections will be completed through this road permit.

In order to facilitate residential development within the Seaton lands in this area, an existing tributary which currently runs south along the east side of Whites Road/Sideline 26 through a roadside ditch will be realigned to cross Whites Road/Sideline 26 through a new box culvert located approximately 300 m upstream of the existing crossing which will be removed. The realigned tributary will cross Whites Road/Sideline 26 through a 2.44 m wide by 1.22 m high by 63.4 m long box culvert which will contain an ecopassage platform on either side within the culvert. The realigned tributary will then flow in an east-west direction along the west side of Whites Road/Sideline 26 and connect to an existing tributary that runs north-south. The realigned east-west channel has been designed to incorporate riffles, pools and transition sections to provide habitat diversity within the new channel segment. Enhancements to a portion of the existing north-south tributary will also need to take place as it will need to accommodate increased flows as a result of the watercourse realignment. Bank treatments have been incorporated into the design of each tributary to provide stability including brush layering, woody habitat treatment, vegetated stone and seed and soil wrapped bank treatments.

As the watercourse feeding the tributary to the south will be realigned and the culvert removed, in order to maintain water balance within that existing reach, drainage from stormwater management (SWM) pond #20 (under a separate review and permitting process) will be directed via a storm pipe to the tributary. The conveyance system and storm outfall pipe from SWM pond #20 will be constructed as part of the Whites Road work.

Road drainage will be treated through a series of SWM ponds which will be constructed within development lands, in parallel with the Whites Road/Sideline 26 work.

Control of Flooding:

The proposed project is not anticipated to impact flooding, conveyance or storage of floodwaters.

Pollution:

Item 11.6.

Standard erosion and sediment control measures, including double sediment fencing with straw bales and rock check dams will be implemented prior to construction and maintained for the duration of construction, and until the site is stabilized.

Dynamic Beaches:

Not applicable.

Erosion:

No geotechnical/slope stability issues have been identified.

Conservation of Land:

The warmwater construction timing window of July 1 to March 31 will apply to this work.

Plantings

All disturbed areas will be stabilized with a native seed mix and plantings along the road alignment (approximately 836 trees, 988 shrubs), as well as along the new realigned channel (approximately 135 trees and 730 shrubs).

Policy Guidelines:

This proposal complies with Section 8.7 Interference with Wetlands, Section 8.8 Interference with a Watercourse and Section 8.9 Infrastructure Policies of The Living City Policies for Planning and Development in the Watersheds of the Toronto and Region Conservation Authority.

CFN: 58869 - Application #: 1305/17/PICK

Report Prepared by: Sharon Lingertat, extension 5717, email slingertat@trca.on.ca

For information contact: Sharon Lingertat, extension 5717, email slingertat@trca.on.ca

Date: April 23, 2019